



30 Fairway Close, Onchan, Isle Of Man, IM3 2EQ
Asking Price £550,000

- Spacious split-level detached bungalow in desirable Onchan location
 - Open-plan kitchen and dining space
- Two double bedrooms and two bathrooms
 - Integral double garage, laundry area and driveway parking
- Large lounge with patio doors onto terrace overlooking rear garden
 - Vacant possession with no onward chain



A spacious split-level detached bungalow occupying a desirable position within sought-after Fairway Close, Onchan. Offered with vacant possession and no onward chain, the property provides generous and versatile accommodation extending to approximately 2,003 sq.ft, including an integral double garage.

The accommodation is arranged over split levels and includes a welcoming entrance foyer, cloakroom WC and a bright, open-plan kitchen and dining area, ideal for everyday living and entertaining. The large lounge is a particular feature of the home, enjoying excellent proportions and patio doors opening onto a terrace overlooking the rear garden.

The bedroom accommodation comprises two well-sized double bedrooms, including a generous primary bedroom, together with two bathrooms, providing practical and flexible living space.

Externally, the property benefits from driveway parking, an integral double garage, laundry area and additional storage/workshop space, making it ideal for those seeking a home with excellent garaging and utility space.

Located in a popular residential area close to Onchan village, local amenities, schools, parks and coastal walks, this is a superb opportunity to purchase a substantial bungalow with scope to personalise if desired.













30 Fairway Close, Onchan, Isle Of Man, IM3 2EQ



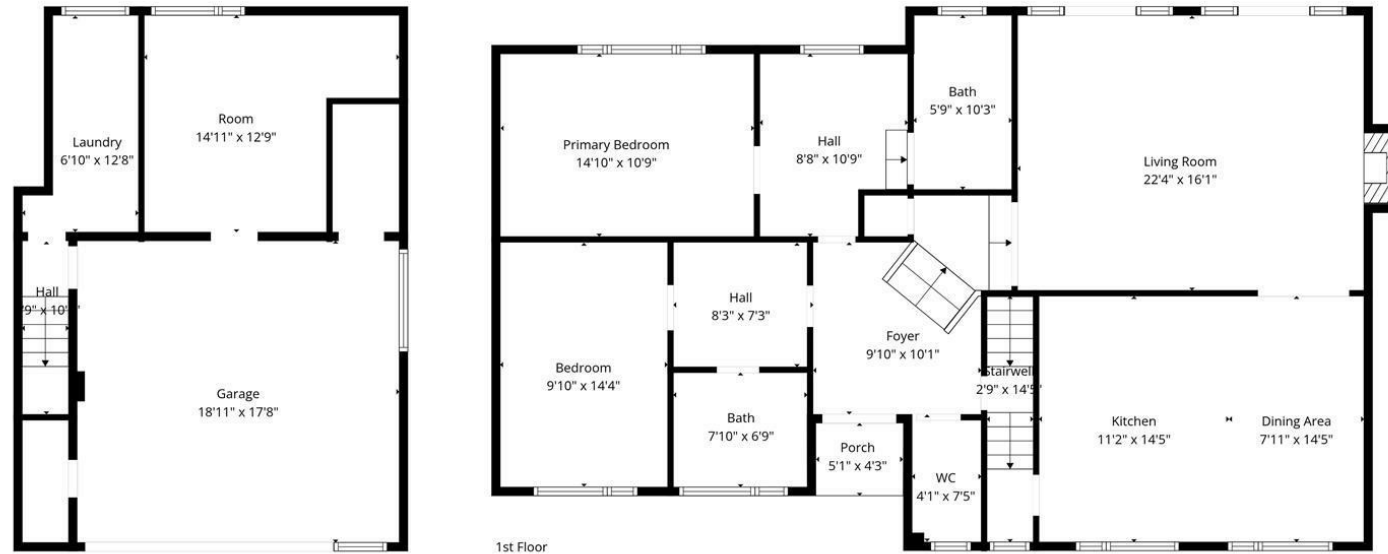

Ground Floor

1st Floor

TOTAL: 2003 sq. ft

Ground floor: 636 sq. ft, 1st floor: 1367 sq. ft

EXCLUDED AREAS: STAIRWELL: 39 sq. ft, PORCH: 22 sq. ft, FIREPLACE: 10 sq. ft,
WALLS: 167 sq. ft

Floor Plan Created By Cubicasa App. Measurements Deemed Highly Reliable But Not Guaranteed.



DOUGLAS

37 VICTORIA STREET
DOUGLAS
ISLE OF MAN IM1 2LF

T 01624 620606

F 01624 677363

E info@deanwood.co.im

CASTLETOWN

COMPTON HOUSE
9 CASTLE STREET CASTLETOWN
ISLE OF MAN IM9 1LF

T 01624 825995

F 01624 825996

E castletown@deanwood.co.im

RAMSEY

LEZAYRE HOUSE
87 PARLIAMENT STREET
RAMSEY ISLE OF MAN IM8 1AQ

T 01624 816111

F 01624 816588

E ramsey@deanwood.co.im

These particulars are for information purposes only. They do not constitute or form any contract nor should any statement contained herein be relied upon as a representation of fact. Neither the vendor nor DeanWood Agencies Limited ('the firm'), nor any officer or employee of the firm accept liability or responsibility for any statement contained herein. The vendor does not by these particulars, nor does the firm, nor does any officer or any employee of the firm have any authority to make or give any representation or warranty whatsoever as regards the property or otherwise. It is the sole responsibility of any person interested in the property described in these particulars to make all proper enquiries and searches to verify the description of the property and all other particulars herein.

FOR MORE PROPERTIES VISIT OUR WEBSITE @ deanwood.im